

Odlučovače ropných látok zo železobetónu, pre zabudovanie do zeme

OLEOPATOR - K

koalescenčné odlučovače ropných látok

Prietok [l/s]	Objem kalovej nádoby [l]	Priemer poklopu	DN pripojenie	B [mm]	C [mm]	T min [mm]	T max [mm]	D priemer [mm]	Najťažší diel [kg]	Celková hmotnosť [kg]	Obj. č.
<b>ACO Oleopator NS 3</b>											
3	300	600	DN 100	395	-870	725	5395	1240	1630	2300	<b>740 501</b>
3	650	600	DN 100	385	-1360	715	5385	1270	2250	2950	<b>740 529</b>
3	900	600	DN 100	500	-1290	1110	5500	1470	2960	4480	<b>743 505</b>

<b>ACO Oleopator NS 6</b>											
6	600	600	DN 150	410	-1335	740	5410	1240	2300	2950	<b>740 587</b>
6	1200	600	DN 150	440	-1510	3180	4680	1470	3180	4680	<b>743 507</b>

<b>ACO Oleopator NS 6 - 10</b>											
6 - 10	-	600	DN 150	420	-845	750	5420	1240	1630	2310	<b>740 563</b>
6 - 10	1000	600	DN 150	440	-1510	1050	5440	1470	3200	4300	<b>747 951</b>
6 - 10	2000	600	DN 150	405	-1675	1015	5406	1800	4700	6850	<b>743 509</b>
6 - 10	2500	600	DN 150	370	-2000	980	5370	1800	5280	7100	<b>743 511</b>
6 - 10	5000	600	DN 150	385	-1925	1185	5385	2440	7950	9850	<b>746 917</b>

<b>ACO Oleopator NS 15</b>											
15	-	600	DN 200	410	-1140	745	3410	1740	4100	5400	<b>747 957</b>
15	1500	600	DN 200	430	-1650	1040	5430	1800	4810	6600	<b>743 523</b>
15	3000	600	DN 200	370	-1410	1170	5370	2440	5750	8900	<b>747 939</b>

<b>ACO Oleopator NS 15 -20</b>											
15 - 20	5000	600	DN 200	390	-2050	1190	5390	2440	7250	10250	<b>746 929</b>

<b>ACO Oleopator NS 20</b>											
20	-	600	DN 200	410	-1140	745	3410	1740	4100	5400	<b>747 955</b>
20	2000	600	DN 200	395	-1975	1005	5395	1800	5440	7100	<b>743 525</b>
20	4000	600	DN 200	345	-1695	1145	5345	2440	6350	9350	<b>746 927</b>
20	6000	600	DN 200	450	-2250	1250	5450	2440	7750	10750	<b>746 931</b>

NS 3 - NS 50

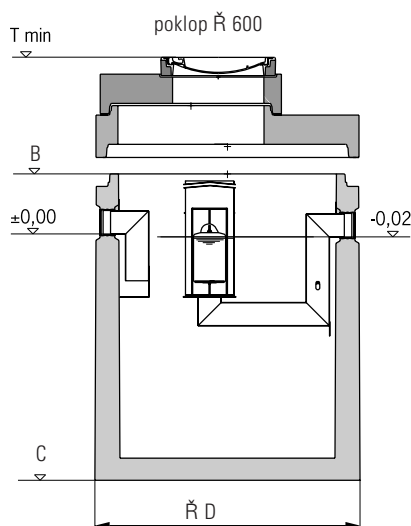

**Legenda**

T min = minimálna hĺbka zabudovania  
T max = maximálna hĺbka zabudovania  
B = vzdialenosť medzi dnom prítokového potrubia a hornou hranou nádrže  
C = vzdialenosť medzi dnom prítokového potrubia a dnom nádrže  
D = priemer nádrže  
Pozn.: Pri výškovom nastavení poklopu treba uvažovať s 10 mm výškou na každú špáru medzi jednotlivými dielcami.

Pozn.: Trieda zataženia poklopu STN EN 124.  
\* NS - menovitá veľkosť (nominal size).

# OLEOPATOR

## NS 15

T min  
0,745

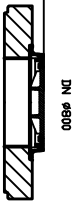

T min  
1,040

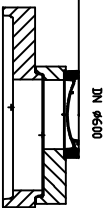

T min  
1,117

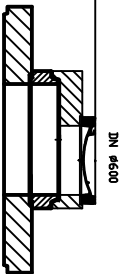

T min  
1,19

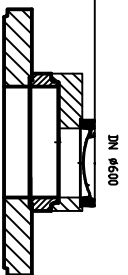

nastavitelné provedení

T min  
0,755

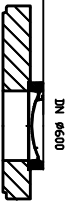

T min  
0,760

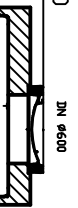

T min  
0,715

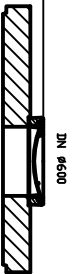

T min  
0,735



základní provedení

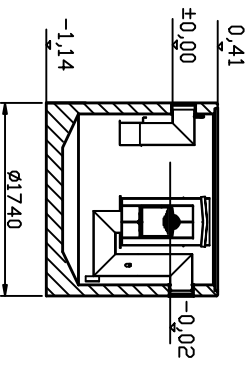

NS15

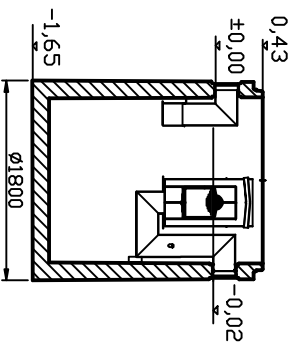
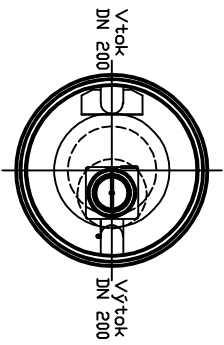

NS15 SRF15001

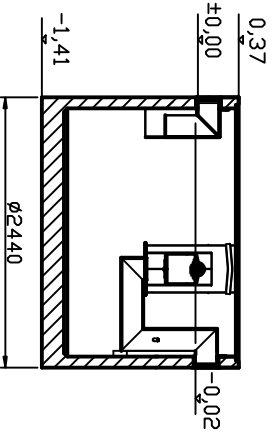
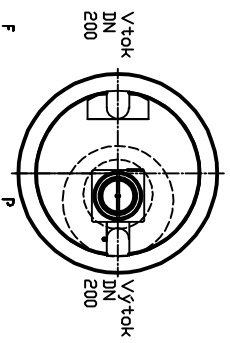

NS15/3000

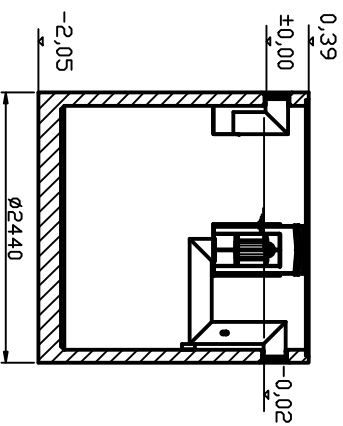
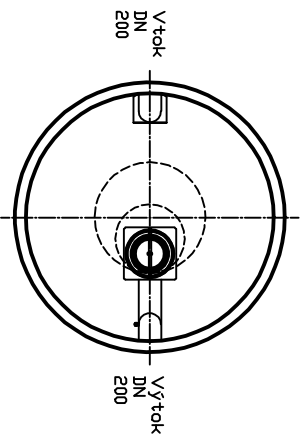

NS15 SRF5001

